

**LOOP LINE  
#140**

**MOUNTING  
INSTRUCTION**

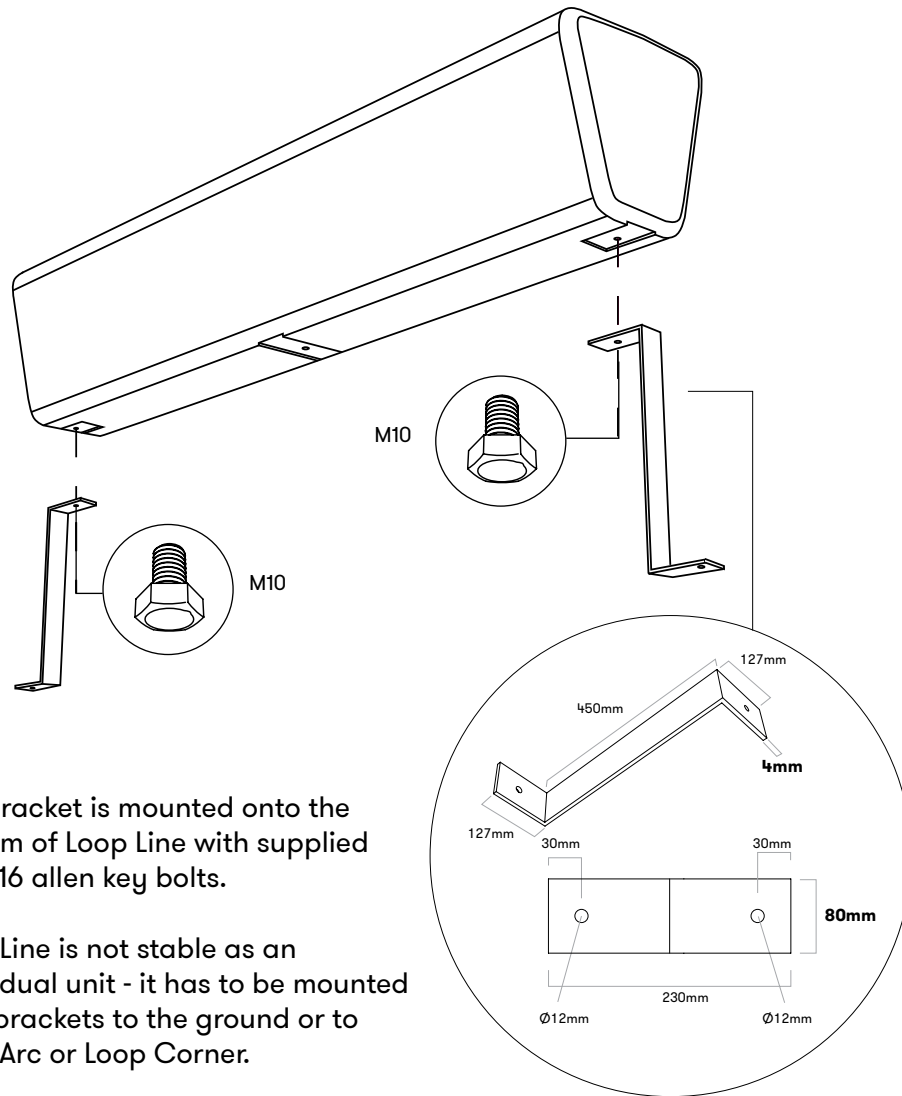

### B2 BRACKET FOR GROUND FIXATION



The bracket is mounted onto the bottom of Loop Line with supplied M10×16 allen key bolts.

Loop Line is not stable as an individual unit - it has to be mounted with brackets to the ground or to Loop Arc or Loop Corner.

### B3 BRACKET FOR SURFACE FIXATION

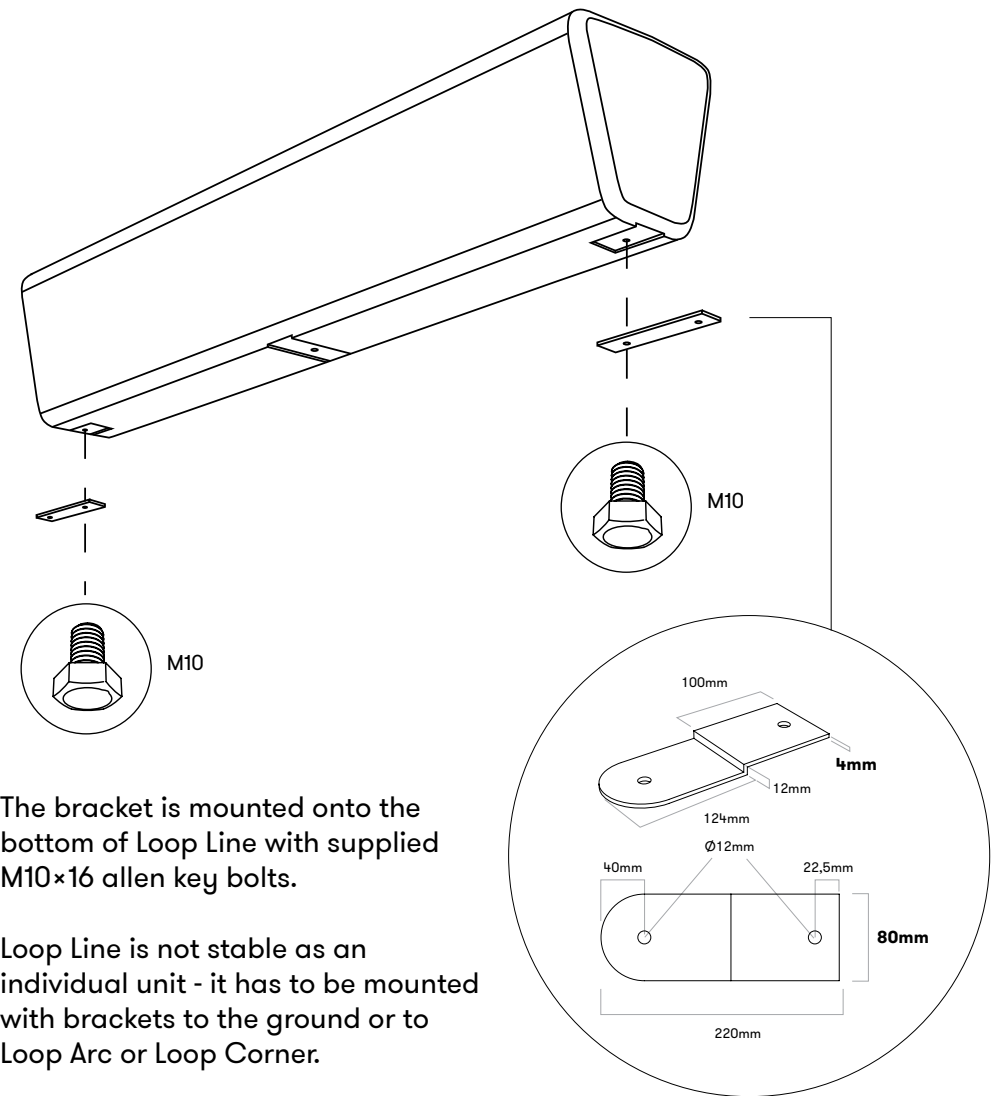

The bracket is mounted onto the bottom of Loop Line with supplied M10×16 allen key bolts.

Loop Line is not stable as an individual unit - it has to be mounted with brackets to the ground or to Loop Arc or Loop Corner.

## SAND BLASTING PLASTIC PRODUCTS

If you wish to hire a company to do the job, seek suppliers called **sand blaster**.

If you want to do the job yourself, equipment can be rented by companies supplying the construction industry. Search for **sand blasting equipment**.

Equipment that will be used to fill in the sand:

- 1) Sand, easiest with *fine blowing sand*  
0.3-1.0mm, oven dried
- 2) Sand pot
- 3) Compressor
- 4) Hose, max Ø50mm

*\*It is recommended to consult professionals as well as instruction manuals on the equipment before it is used.*



1) Sand



2) Sand pot



3) Compressor



4) Hose, max Ø50mm

### B5 BRACKET FOR GROUND FIXATION, MIDDLE

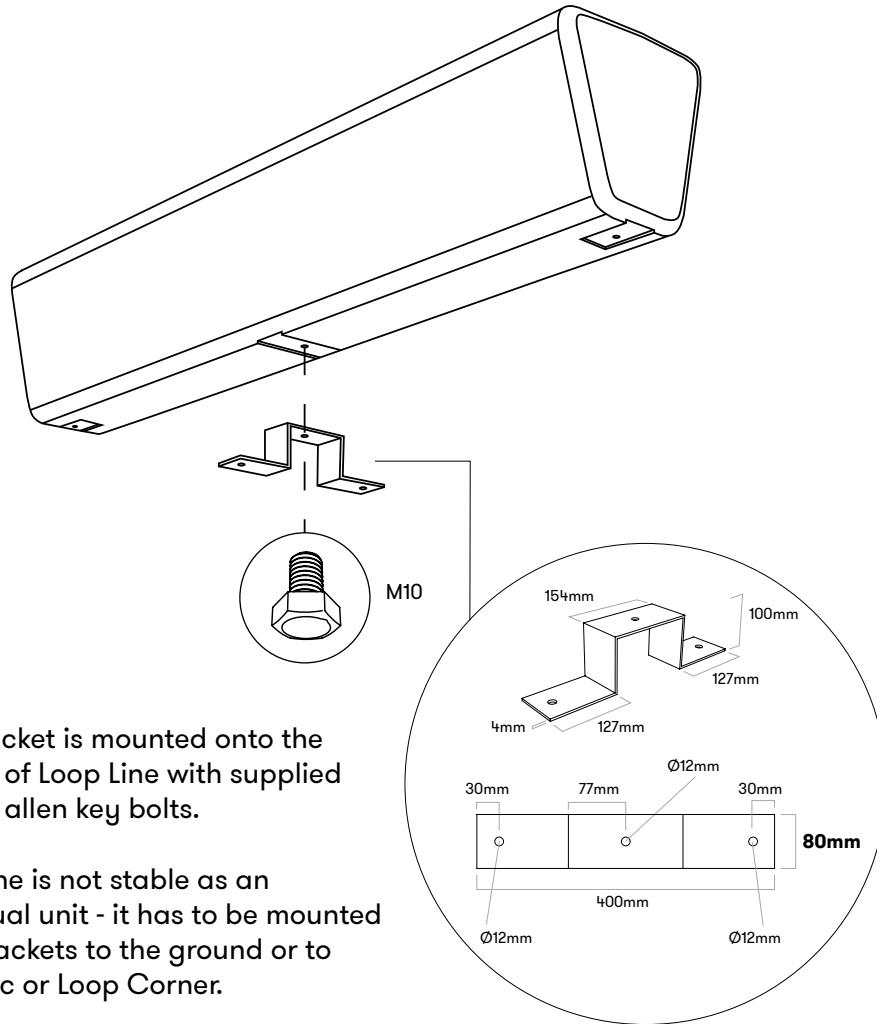

The bracket is mounted onto the bottom of Loop Line with supplied M10×16 allen key bolts.

Loop Line is not stable as an individual unit - it has to be mounted with brackets to the ground or to Loop Arc or Loop Corner.

### B6 BRACKET FOR SURFACE FIXATION, MIDDLE

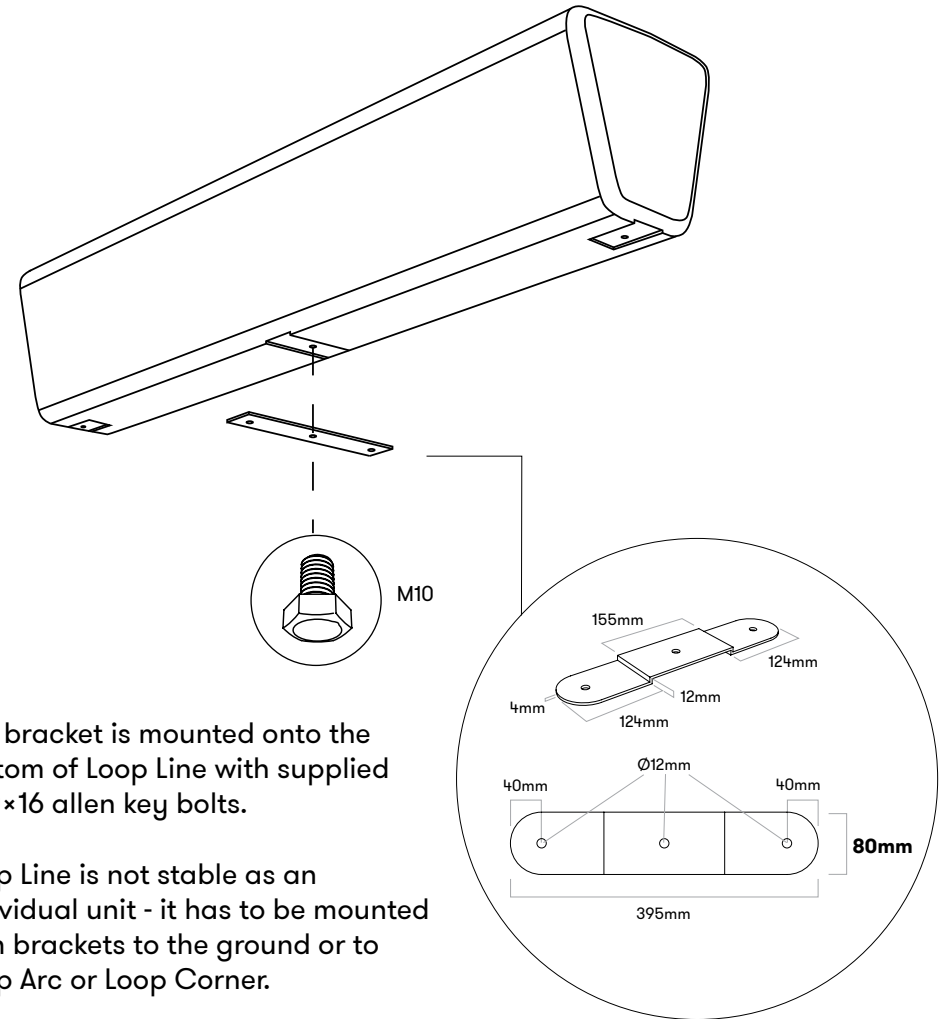

The bracket is mounted onto the bottom of Loop Line with supplied M10×16 allen key bolts.

Loop Line is not stable as an individual unit - it has to be mounted with brackets to the ground or to Loop Arc or Loop Corner.

## #209 ARMREST

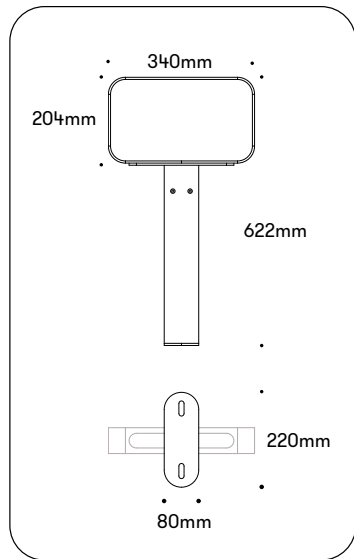
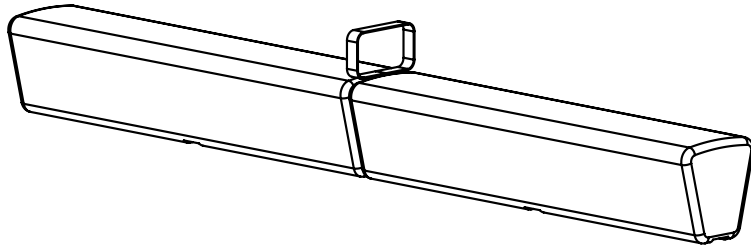

The armrest is placed between 2 modules.

At the same time, the armrest also works as an assembly bracket between 2 modules, which is why B4 brackets are not used.

1. The armrest is first mounted at the bottom of one Line with the supplied bolts.
2. The armrest is attached to the end of Line with the supplied 2 self-tapping screws.
3. Finally, mount the second Line to the bracket.

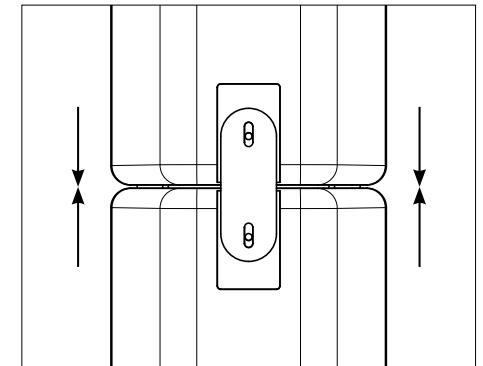
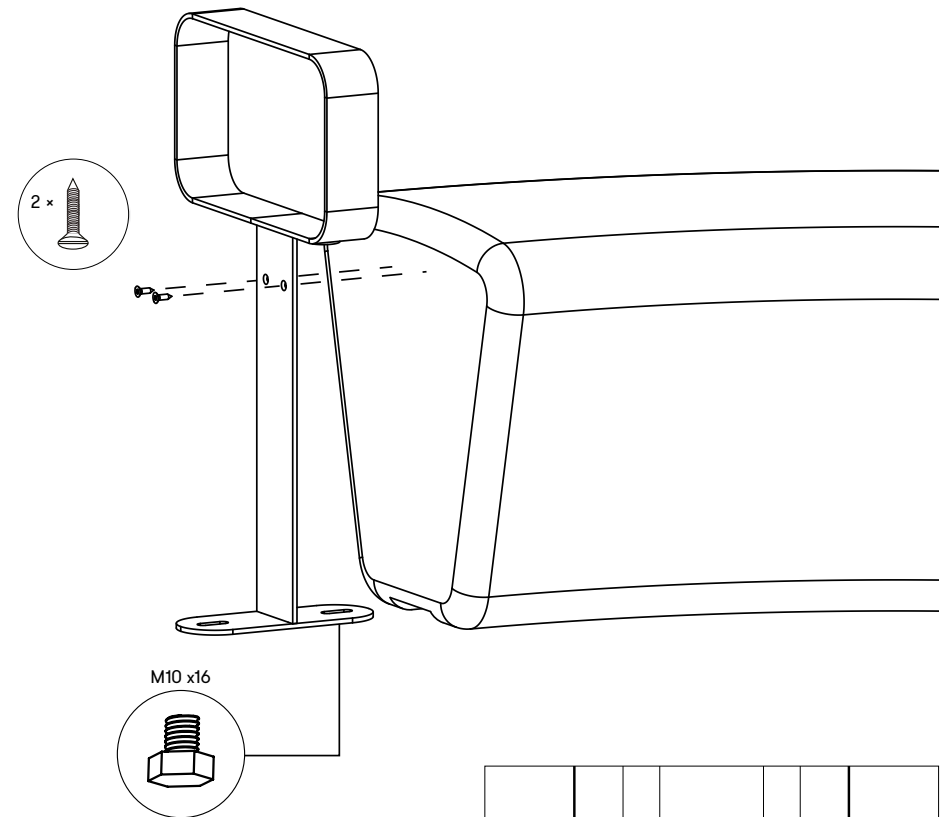

**NOTE!** Hold the two modules close together when the bolts at the bottom are tightened.

## B4 ASSEMBLY BRACKET

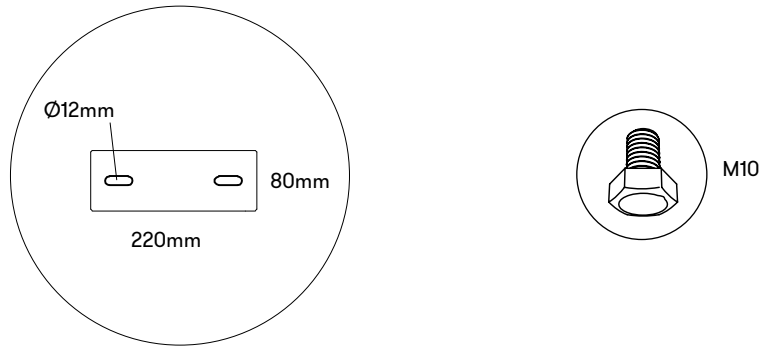

The assembly bracket functions as a spacer between the ends of two Loop Lines. The bracket is adjustable (0-50mm).

Each bracket is mounted onto the bottom of each Loop Line with the supplied M10×16 bolts.

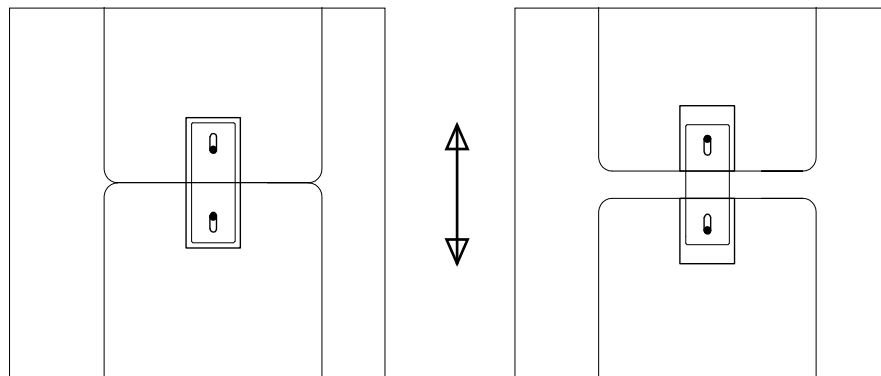

## CLEANING INSTRUCTIONS

Polyethylene can withstand almost all cleaning agents.

The material does not need to be maintained.

Preserves the colours.

A high-pressure cleaner can be used for cleaning the product.

## NON-SLIP SURFACES

Because of the surface treatment of the mould, a rough surface is obtained in the final product. This process increases the friction and thereby makes the surface less slippery.